

SoutheastCORRIDOR

FALL 2009

RTD FASTTRACKS SOUTHEAST QUARTERLY NEWS LINK

Times

COMING SOON TO A PUBLIC MEETING (OR LIBRARY AND ONLINE) NEAR YOU:

THE SOUTHEAST CORRIDOR EXTENSION ENVIRONMENTAL EVALUATION!

For the last year and a half, a team of planners and engineers has been working hard on the Southeast Corridor Extension Environmental Evaluation (EE) and Basic Engineering (BE). An EE is a process done by the Regional Transportation District (RTD) to fulfill the RTD Board of Directors' commitment to perform the same level of environmental planning on all FasTracks corridors and projects. The Southeast Corridor Extension is part of a program to extend rail transit through the eight-county Denver metro area.

Now the planners and engineers have finished their work and are looking to you for feedback on the findings of this study. Join us for the third and final public meeting for this phase of the project, where you will learn about:

- The findings of the environmental study
- The selected alignment and station locations for the extension of light rail into your community.
- How this line fits into the overall FasTracks system

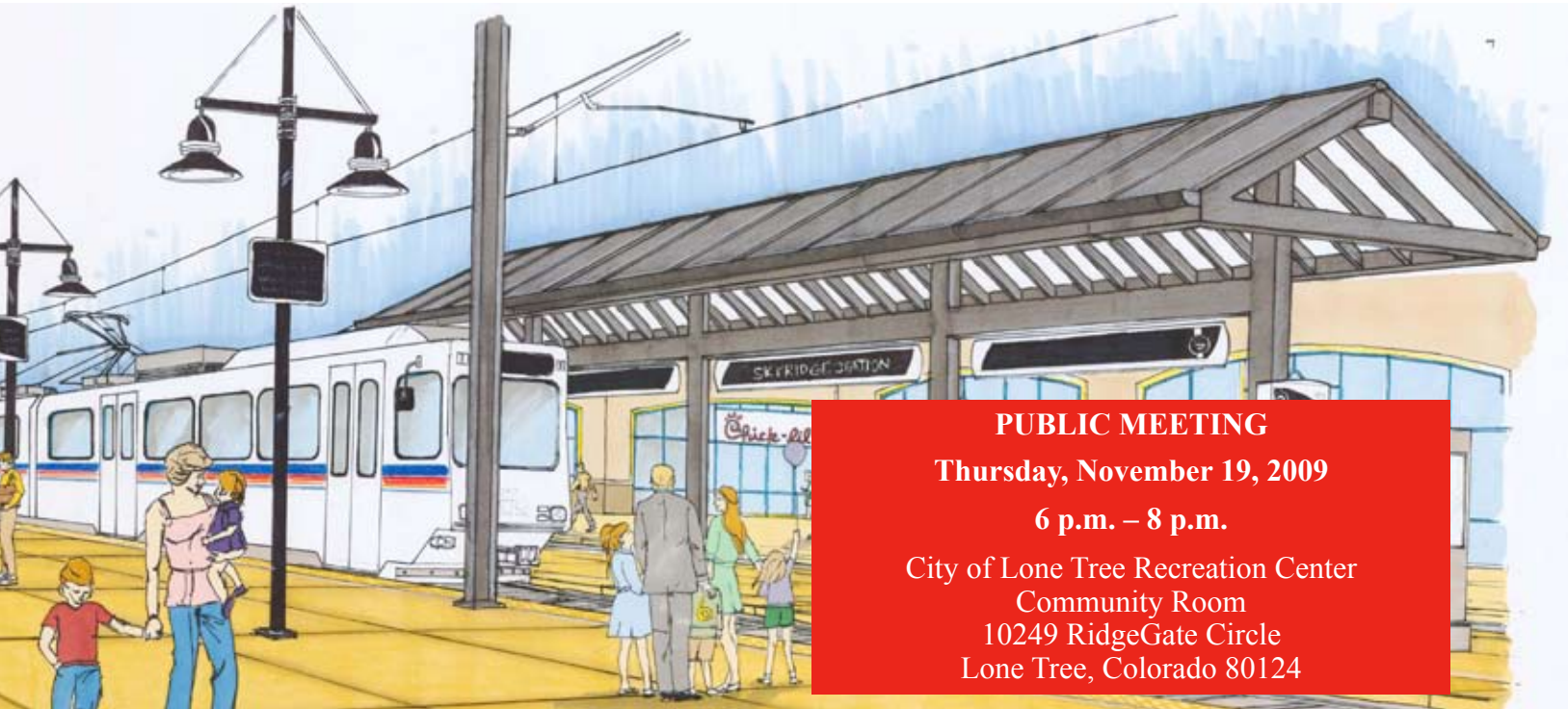

PUBLIC MEETING

Thursday, November 19, 2009

6 p.m. – 8 p.m.

City of Lone Tree Recreation Center
Community Room
10249 RidgeGate Circle
Lone Tree, Colorado 80124

WHAT'S INSIDE

- Top Ten Things You Should Know About the Southeast Corridor Extension, Pages 2 – 3

If you can't join us on the Nov. 19, feel free to view and comment on the Southeast Environmental Evaluation at your local library or online at www.RTD-FasTracks.com. Click on the Southeast tab, where we have created an innovative map that will provide you with a comprehensive, interactive, version of our EE document.

The Top Ten Things You Should Know about the Southeast Corridor Extension

1 Your community is growing. The long-term plans for Lone Tree include the RidgeGate development, which is projected to include mixed-use housing, commercial, high density town center and nearly 30,000 residents. An extension of light rail in the Southeast Corridor is needed to address development and growth in

Douglas County and Lone Tree, improve local and regional travel options, provide a reliable alternative to the automobile, and meet the 2004 voter mandate.

2 This project represents an opportunity to plan transit and development simultaneously. The Southeast Light Rail line will be extended 2.3 miles from the current end-of-line just north of Lincoln Avenue to the south side of the I-25/RidgeGate Parkway interchange. The planned alignment runs south along the west side of the I-25 corridor from Lincoln Station; over Lincoln Avenue to the Sky Ridge Medical Center. From this point, the alignment turns east and crosses over I-25; then proceeds south along the east side of the I-25 corridor through the RidgeGate planned development and the proposed Lone Tree City Center before continuing south to RidgeGate Parkway. The RidgeGate Planned Development and the Lone Tree City Center is an approved, though undeveloped, commercial mixed-use project that will be integrated with the proposed transit facilities. The light rail extension will be at-grade through most of the proposed Lone Tree City Center so that it is integrated into the fabric of this proposed intensely developed area.

3 The planned line will limit interference with traffic. All major road crossings along this line are grade-separated or will not interact with traffic. At Lincoln Avenue, I-25 and Sky Ridge Avenue, the alignment is elevated on bridges. At RidgeGate Parkway the light rail tracks pass under the roadway. Potential at-grade crossings are at local streets north of Sky Ridge Medical Center (1 potential crossing) and local streets within the RidgeGate development (up to 2 crossings) east of I-25.



Southeast Corridor Light Rail Extension

4 Take the easy way to Sky Ridge Medical Center. The Sky Ridge Station is positioned just north of Sky Ridge Avenue, directly across from the Sky Ridge Medical Center. The station will be constructed at-grade and will include two kiss-n-Ride drop-off areas along Sky Ridge Avenue and a future local street. Bus pullouts on either side of Sky Ridge Avenue allow for convenient transfers between bus and light rail. The station layout includes pedestrian amenities that will benefit those visiting the medical facility, as well as those visiting the commercial developments planned immediately north of the station.

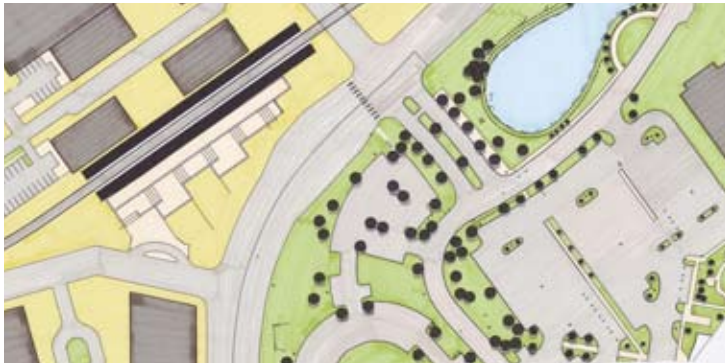

Sky Ridge Station

5 Ride to the soon-to-be heart of Lone Tree. The Lone Tree City Center Station is situated in the core of RidgeGate Planned Development, an intensely developed, mixed-use area where building heights can reach 30 stories. The station will be integrated into this urban setting and constructed at-grade. Patrons will access the City Center Station primarily by foot and bus. The station design will provide for ample bicycle parking and ease of access for pedestrians in all directions. A detailed station plan for the Lone Tree City Center Station will be devised as development plans mature for City Center.

6 There will be 2,000 new parking spots. The end-of-line station at RidgeGate Parkway is the only planned station to include a park-n-Ride facility for 2,000 cars. Most people will arrive at the RidgeGate Parkway Station by car; however, the station will also include facilities to accommodate pedestrians and bicyclists. The end-of-line station will include kiss-n-Ride drop-off and bus transfer areas near the platform.

7 Light rail and bus service will be planned to increase convenience and respond to ridership. With construction and operation of the Southeast Corridor Extension, the FastTracks Plan provides for increased frequencies of trains on the E, F, and G lines. Likewise, bus service will be modified to take advantage of the extended service. The final operations plan has not yet been determined, but will continue to be studied as the design process for the corridor progresses.



RidgeGate Toward Legacy

8 The impacts of the alignment, stations and construction are minimal. Through the EE process, the Southeast Corridor Extension Project Team examined the affected environment, potential impacts, and recommended needed mitigation for the extension. Though no major impacts were identified, there are areas with minor impacts, including right of way (no homes or businesses will be impacted), historic resources, archaeological, natural resources, water and wetlands impacts, visual and aesthetic resources and transportation and biological resources. All of these will be addressed through mitigation measures to reduce or eliminate impacts. These measures include best management practices such as using erosion and sedimentation controls during construction, adding stormwater controls to the stations, and landscaping.

9 Other agencies have weighed in on this plan. The Southeast Corridor Project Team has worked closely with the City of Lone Tree, Douglas County, Coventry Development Corporation (the developer for RidgeGate planned development) and Sky Ridge Medical Center throughout the project to identify and resolve issues related to the light rail alignment and station locations.

10 You have a voice in this process. The general public and key community groups were involved through public meetings, Web site updates, project newsletters and individual meetings with businesses and neighborhood associations. Several organizations were actively engaged in the planning process, including the many Lone Tree Homeowners' Associations (HOAs).

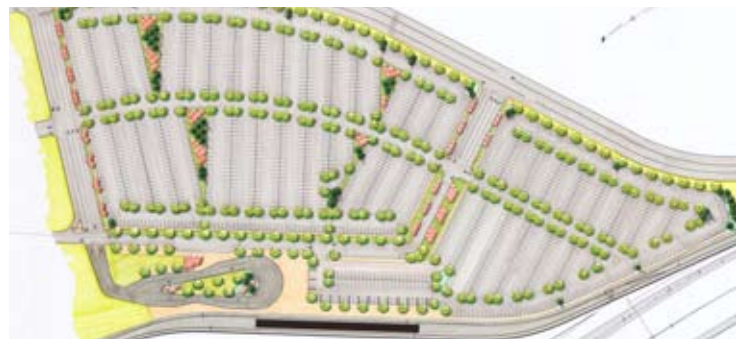

RidgeGate Parkway Station Layout

FOR MORE INFORMATION

Web site:

www.RTD-FasTracks.com
Click on SE Corridor

Email:

secorridor@RTD-FasTracks.com

Hotline:

(303) 299-2000, follow the prompts

Mail: RTD FasTracks,
Attn: Tina Jaquez
1560 Broadway,
Suite 700, Denver, CO 80202

Contacts:

Amy Ford
SE Corridor Public Involvement Specialist:
(303) 514-4913

Tina Jaquez
SE Corridor FasTracks Liaison:
(303) 299-6902

MILESTONES:

- Scoping/Defining Purpose and Need for the Project – Fall 2008
- Alternative Development/Environmental Evaluation – Spring/Summer 2009
- Final Results – Fall/Winter 2009

You are invited!

FasTracks Southeast Corridor Extension Public Meeting/Open House

Thursday, November 19, 2009

6 p.m. – 8 p.m.

City of Lone Tree Recreation Center
Community Room
10249 RidgeGate Circle
Lone Tree, Colorado 80124

Your input is extremely valuable in helping RTD to finish the planning of the Southeast Corridor extension. Please join us to share final comments about the Environmental Evaluation.

Web/Phone

For questions and/or to be notified of future public meetings, visit the project Web site at www.RTD-FasTracks.com and click on Southeast Corridor, or call (303) 299-2000 and follow the prompts.

*Para información en
español, visite
RTD-FasTracks.com
y pulse el enlace con
el Corredor Suroeste
o llame
al 303-299-2000.*

*Si necesita ayuda para
la reunión pública,
llame al 303-803-2941.*

Communication Assistance Available

The following communication assistance is available for Regional Transportation District public meetings: language interpreters, sign-language interpreters, assisted listening devices, alternative formats such as large print or reasonable accommodations for special needs. Contact RTD at (303) 803-2941 at least 72 hours prior to the meeting to discuss your special needs and request for accommodation.



RTD-FasTracks
1560 Broadway, Suite 700
Denver CO 80202

